



HARIOM TOWER

PUNDAG

The Heart Of Urban Living!





Green Retreat



Landscaped Garden



Vastu Compliant



Children's Play Area

A harmonious residential haven, seamlessly blending modern luxury with nature's embrace. Serene landscapes, sustainable design, and vibrant community living. Elevate your lifestyle in this lush, eco-friendly sanctuary.



Garden View



Health Retreat



Gymnasium



Open Air Landscaped Yoga



Walking/Jogging Track

Discover tranquility at a residential haven where nature meets luxury. Immerse yourself in lush landscapes, modern comforts, and a serene ambiance. Your dream home awaits amidst nature's embrace.



Terrace Kid's Play Area



Terrace Sitting Area



Fresh Breath



24 X 7 Security

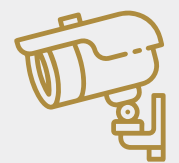

CCTV Camera for Common Area

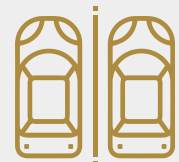

Visitors Car Parking Space

Ensuring your safety is our top priority. Our residential complex strictly adheres to security compliance standards, employing state-of-the-art measures to create a secure and peaceful living environment for all residents.





Children's Play Area



Specifications



FRAME STRUCTURE

RCC-framed structure with anti-termite treatment in foundation

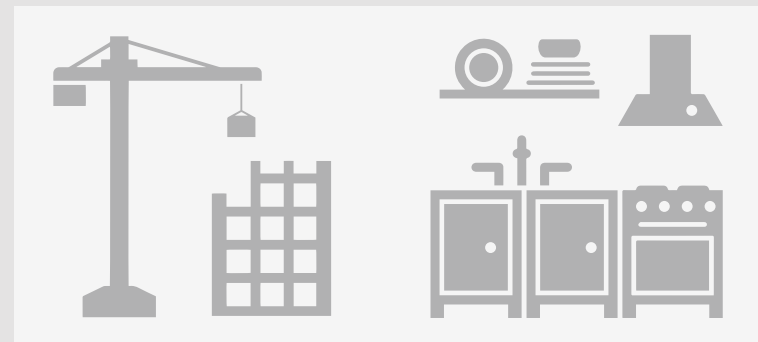

KITCHEN

Flooring : Anti skid floor tiles
Working platform : Granite
Dado : Ceramic tiles upto 2' height
Sink : Stainless steel
Water line : CPVC pipe line with hot and cold water supply
Modular kitchen : On extra charge



GARDEN

As per landscape consultants

DOORS & WINDOWS

Main door : Designer door / Flush door
Other doors : Flush door
Chowkhats : Sal wood / Sal hard wood
Window : 3 track UPVC / Aluminium



TOILETS

Sanitary ware : Hindware / Roca / Kohler / Grohe / equivalent
CP fittings : Hindware / Roca / Kohler / Grohe / Jaguar / equivalent
Water line : CPVC pipe line with hot and cold water supply

COMMUNICATION

T.V. and telephone points as per drawing

FLOORING INTERNAL

Bedroom / master bedroom : Vitrified tiles
Other bedrooms : Vitrified tiles
Toilets : Anti skid floor tiles edge cut
Dado : Ceramic tiles upto lintel level
Drawing room : Vitrified tiles
Dining room : Vitrified tiles

FLOORING EXTERNAL

Foyer : Granite / Vitrified Tiles
Stairs : Granite / Vitrified Tiles
Parking : Paving tiles

WALL FINISH

Internal : Primer over P.O.P
External : Combination of glass / exterior tiles / textures / weather coat paint

DINING ROOM

Wash basin - Point



RAILING

Internal : Combination of stainless steel, mild steel, cast iron
Balcony : Combination of stainless steel, mild steel, cast iron

ELECTRICAL

Wiring : Concealed electrical wiring of Polycab / R.R cables / Finolex / Havells / equivalent
Switches : Modular switches of Anchor / GM / Legrand / equivalent

LOBBY / PASSAGE & STAIRS

Marble / Vitrified tiles

SECURITY

Intercom & CCTV

ELEVATOR

Total number of elevator - 10

Location Map



Key Distances

- Mannat Hospital - 1.6 Km
- DAV Alok Public School - 2 Km
- Patel College of Nursing - 1.8 Km
- Indian Institute Of Management (IIM) - 3.3 Km
- Swastik Ent Centre & Hospital - 4.9 Km
- Kathal More Chowk - 2 Km
- Daladili Chowk - 3.5 Km
- Shree Krishna Pranami Mandir - 900 Mtr

Location Map

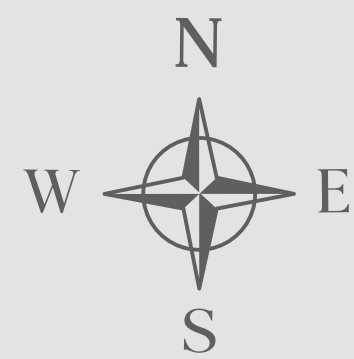
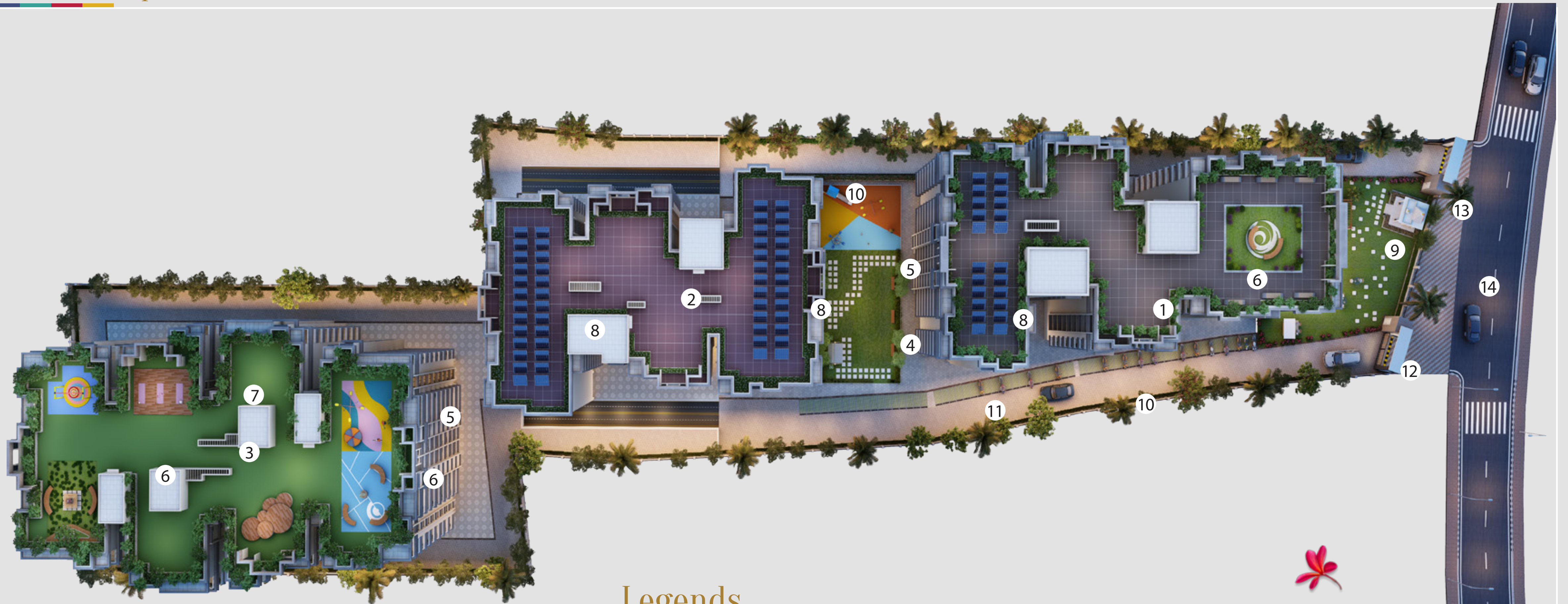

Legends

- | | | | | |
|------------|-------------------|----------------|------------------|----------|
| 1. Block A | 4. Lawn | 7. Yoga Deck | 10. Driveway | 13. Exit |
| 2. Block B | 5. Kids Play Area | 8. Solar Panel | 11. Parking Zone | 14. Road |
| 3. Block C | 6. Sitting Area | 9. Temple | 12. Entry | |



Floor Plan

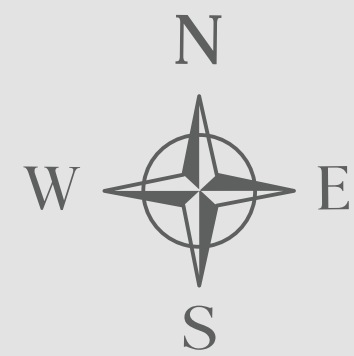
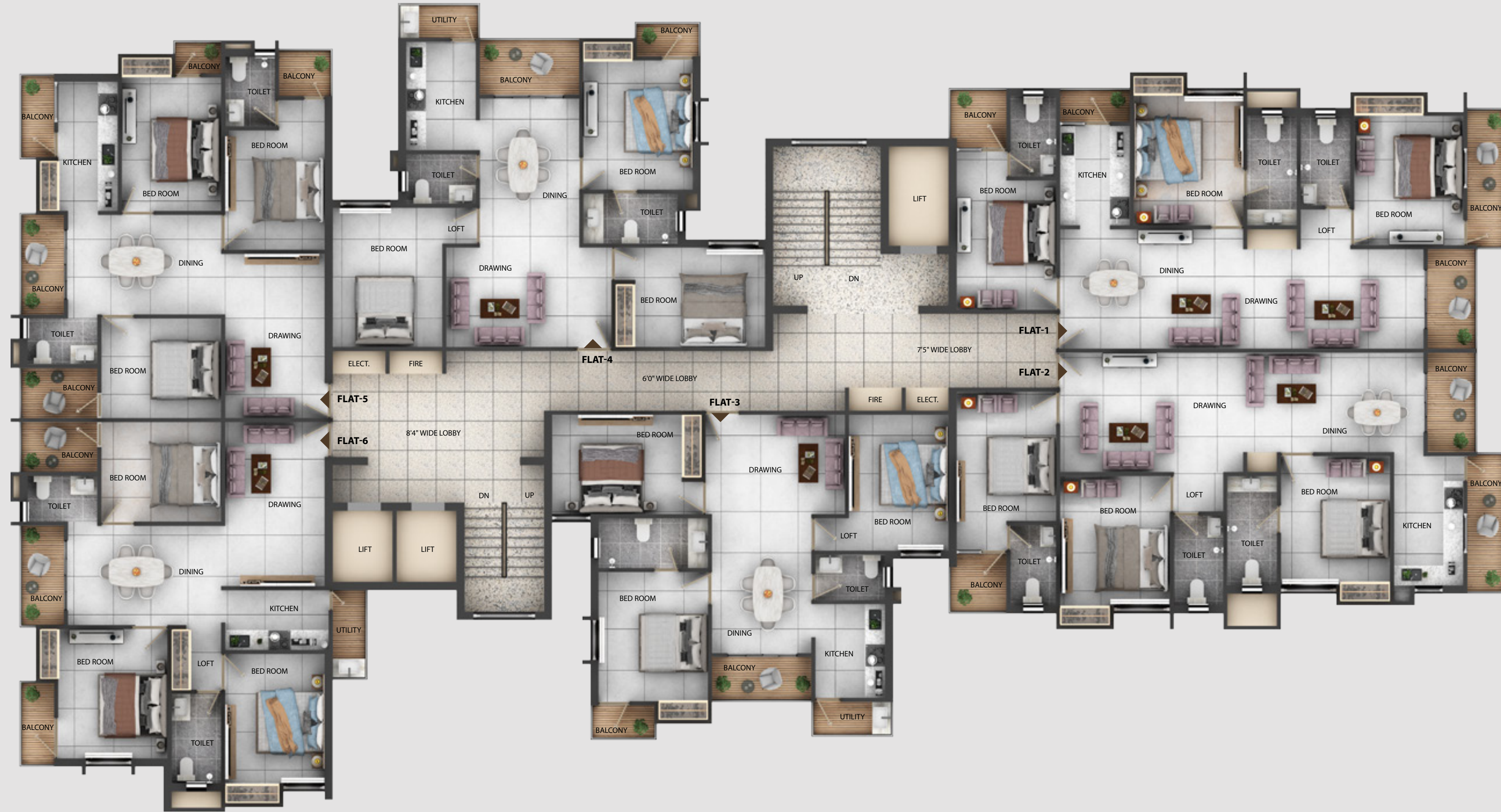

Block-A | Typical 1st To 9th Floor

FLAT	TYPE	CARPET AREA	BUA	SBUA	UNIT	TYPE	CARPET AREA	BUA	SBUA
FLAT-1	3 BHK	1303 SQFT	1376 SQFT	1720 SQFT	FLAT-4	3 BHK	1087 SQFT	1169 SQFT	1461 SQFT
FLAT-2	3 BHK	1297 SQFT	1369 SQFT	1711 SQFT	FLAT-5	3 BHK	1067 SQFT	1139 SQFT	1424 SQFT
FLAT-3	3 BHK	1015 SQFT	1089 SQFT	1361 SQFT	FLAT-6	3 BHK	1088 SQFT	1171 SQFT	1464 SQFT



Unit Plans



Block-A | Typical 1st To 9th Floor

FLAT	1
TYPE	3 BHK
CARPET AREA	1303 SQFT
BUA	1376 SQFT
SBUA	1720 SQFT

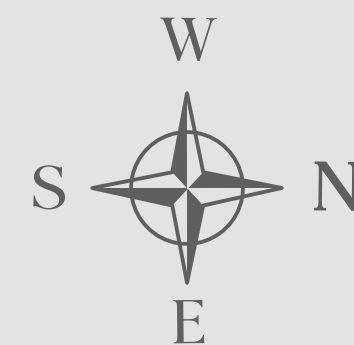
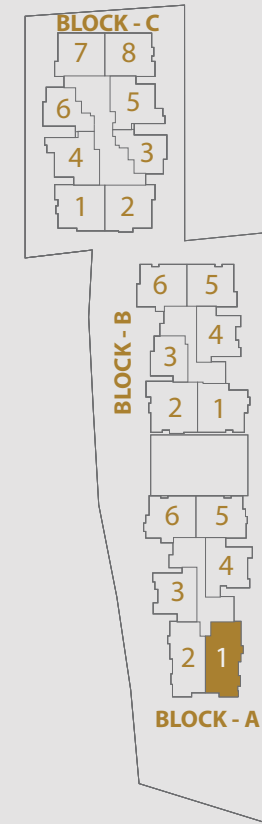

Block-A | Typical 1st To 9th Floor

FLAT	2
TYPE	3 BHK
CARPET AREA	1297 SQFT
BUA	1369 SQFT
SBUA	1711 SQFT

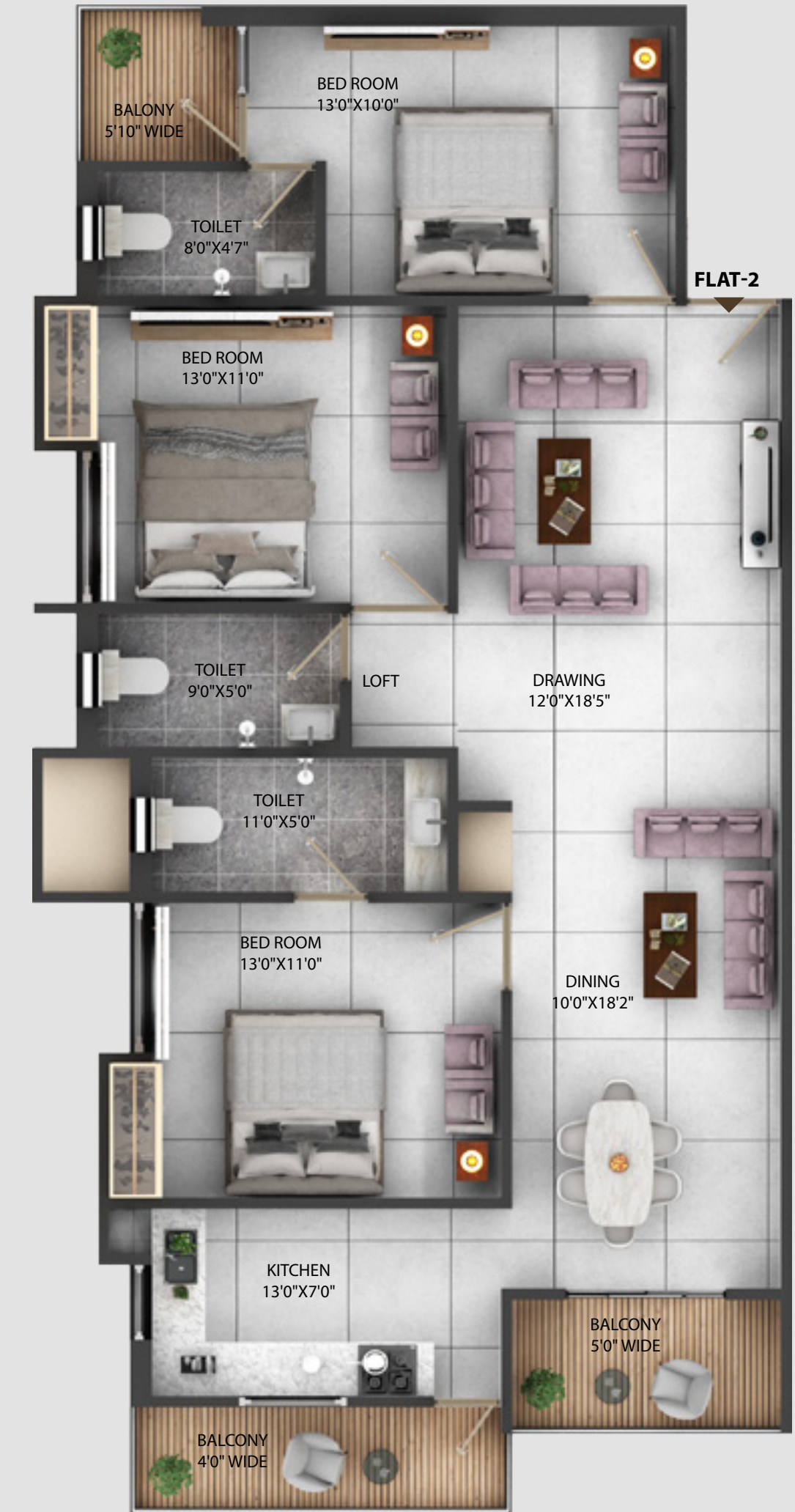
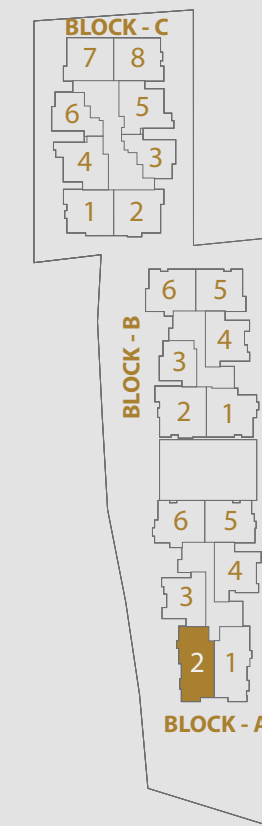

Unit Plans



FLAT-3

Block-A | Typical 1st To 9th Floor

FLAT	3
TYPE	3 BHK
CARPET AREA	1015 SQFT
BUA	1089 SQFT
SBUA	1361 SQFT

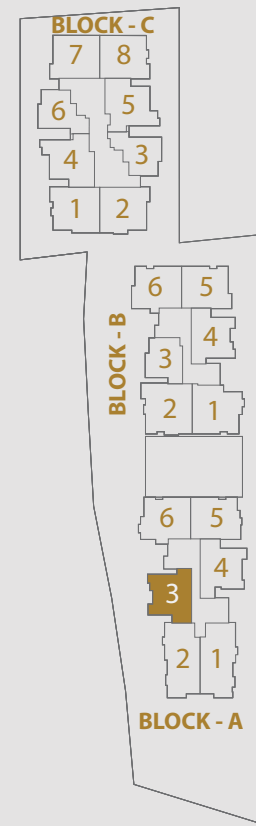

Block-A | Typical 1st To 9th Floor

FLAT	4
TYPE	3 BHK
CARPET AREA	1087 SQFT
BUA	1169 SQFT
SBUA	1461 SQFT

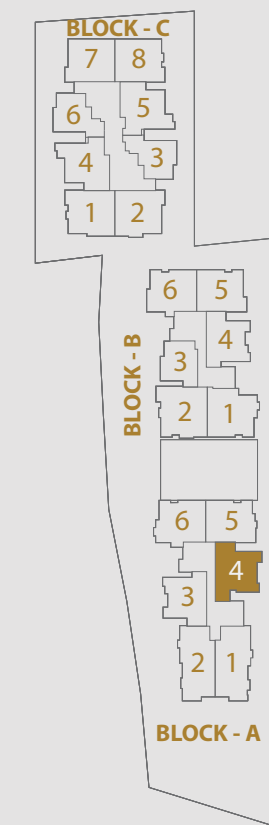

FLAT-4



Unit Plans



FLAT-5

Block-A | Typical 1st To 9th Floor

FLAT	5
TYPE	3 BHK
CARPET AREA	1067 SQFT
BUA	1139 SQFT
SBUA	1424 SQFT

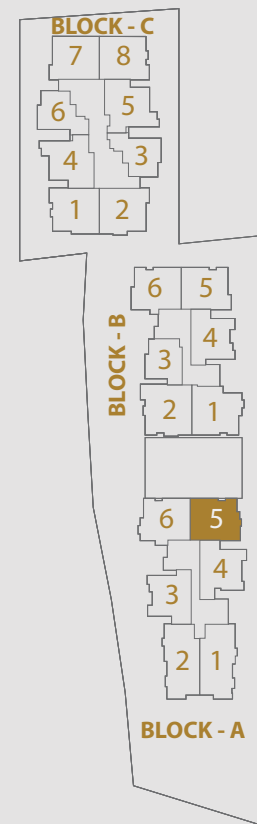

Block-A | Typical 1st To 9th Floor

FLAT	6
TYPE	3 BHK
CARPET AREA	1088 SQFT
BUA	1171 SQFT
SBUA	1464 SQFT

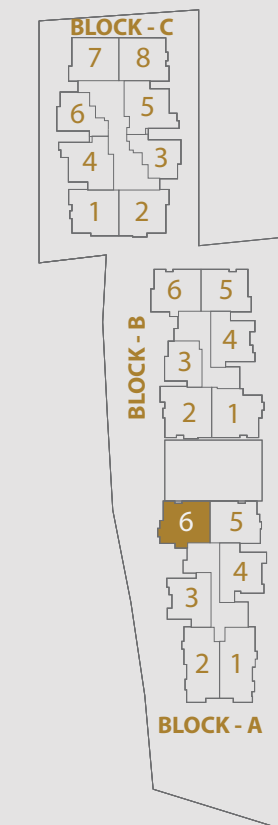

FLAT-6



Floor Plan

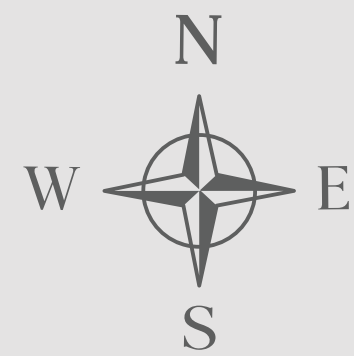
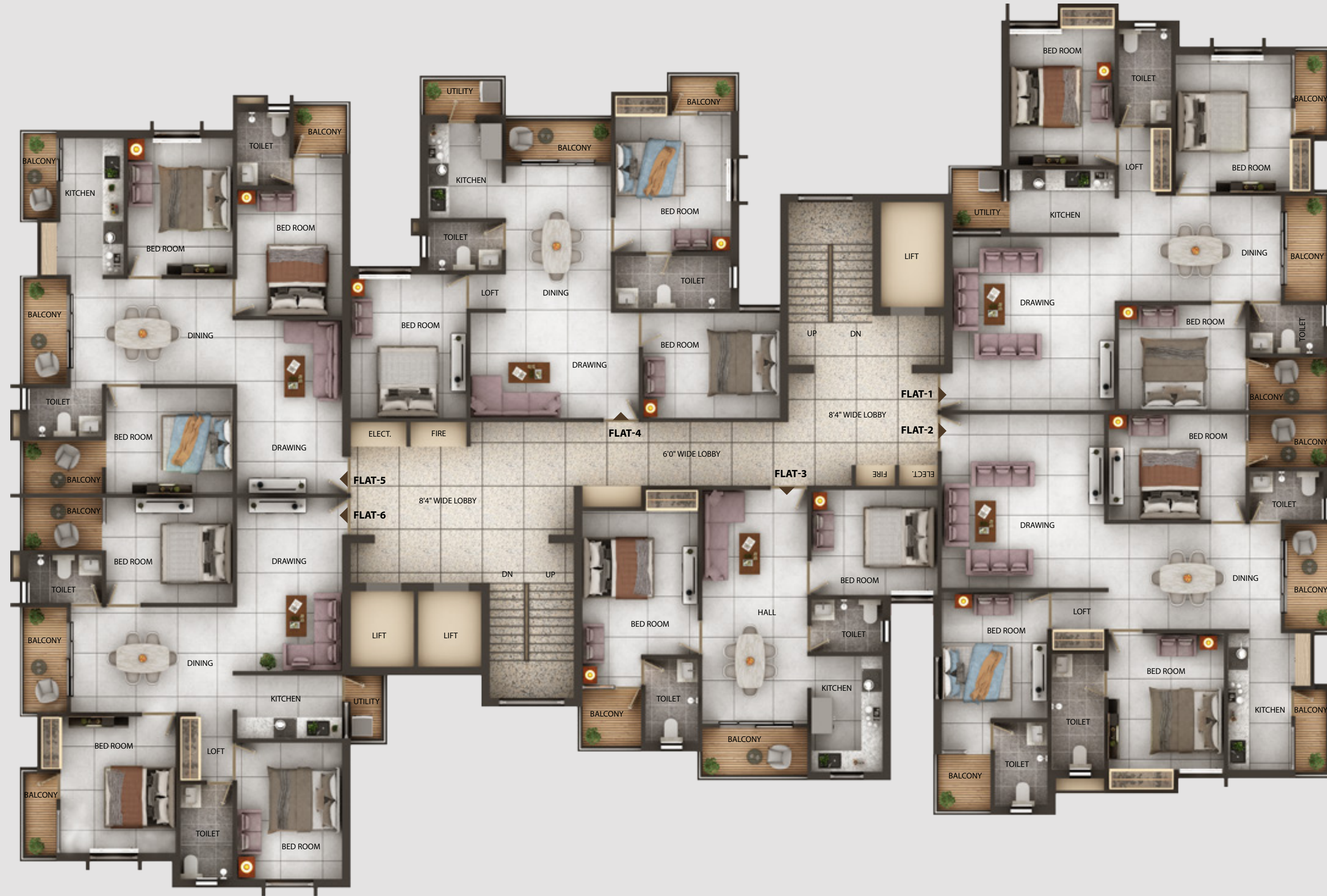

Block-B | Typical 1st To 9th Floor

FLAT	TYPE	CARPET AREA	BUA	SBUA	UNIT	TYPE	CARPET AREA	BUA	SBUA
FLAT-1	3 BHK	1177 SQFT	1261 SQFT	1576 SQFT	FLAT-4	3 BHK	1025 SQFT	1106 SQFT	1383 SQFT
FLAT-2	3 BHK	1282 SQFT	1366 SQFT	1708 SQFT	FLAT-5	3 BHK	1036 SQFT	1112 SQFT	1390 SQFT
FLAT-3	2 BHK	778 SQFT	838 SQFT	1048 SQFT	FLAT-6	3 BHK	1067 SQFT	1151 SQFT	1439 SQFT



Unit Plans

FLAT-1



Block-B | Typical 1st To 9th Floor

FLAT	1
TYPE	3 BHK
CARPET AREA	1177 SQFT
BUA	1261 SQFT
SBUA	1576 SQFT

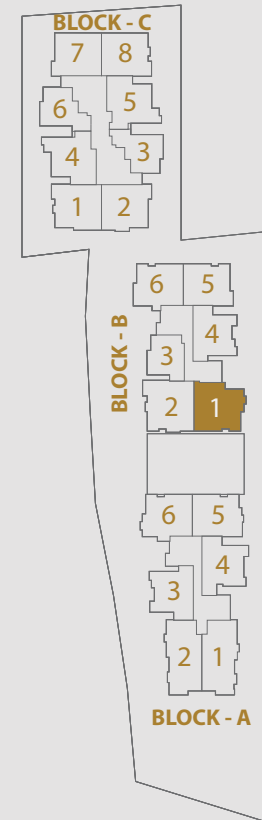

Block-B | Typical 1st To 9th Floor

FLAT	2
TYPE	3 BHK
CARPET AREA	1282 SQFT
BUA	1366 SQFT
SBUA	1708 SQFT

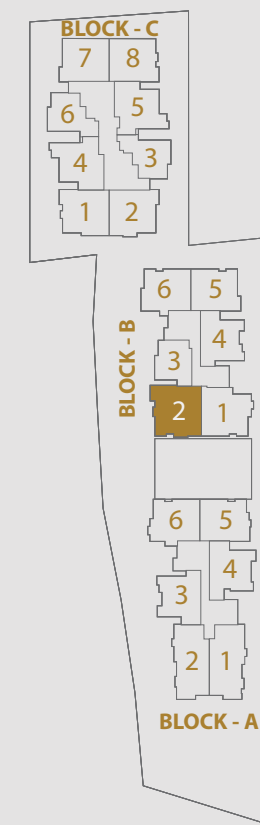

FLAT-2



Unit Plans



FLAT-3

Block-B | Typical 1st To 9th Floor

FLAT	3
TYPE	2 BHK
CARPET AREA	778 SQFT
BUA	838 SQFT
SBUA	1048 SQFT

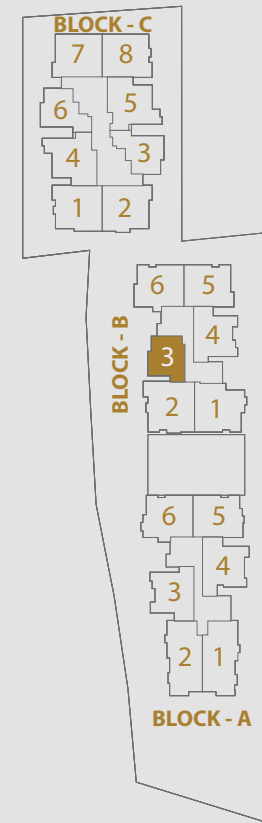

Block-B | Typical 1st To 9th Floor

FLAT	4
TYPE	3 BHK
CARPET AREA	1025 SQFT
BUA	1106 SQFT
SBUA	1383 SQFT

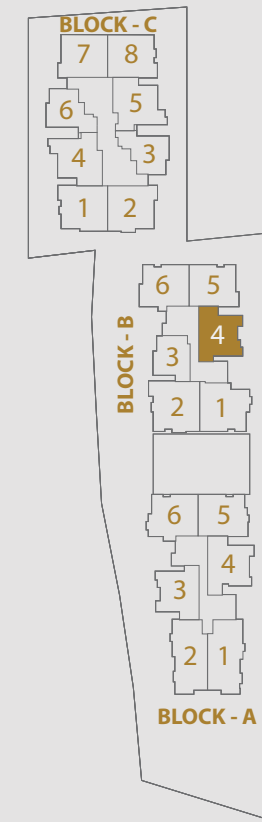

FLAT-4

Unit Plans



FLAT-5

Block-B | Typical 1st To 9th Floor

FLAT	5
TYPE	3 BHK
CARPET AREA	1036 SQFT
BUA	1112 SQFT
SBUA	1390 SQFT

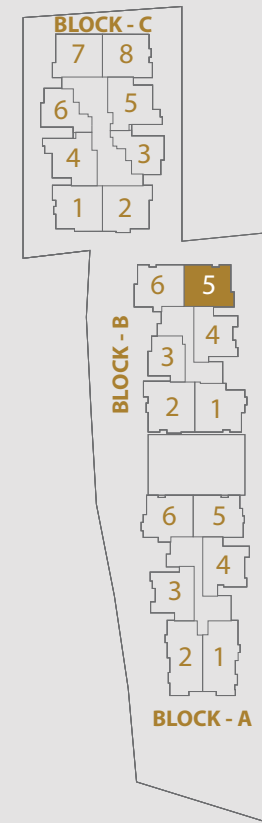

Block-B | Typical 1st To 9th Floor

FLAT	6
TYPE	3 BHK
CARPET AREA	1067 SQFT
BUA	1151 SQFT
SBUA	1439 SQFT

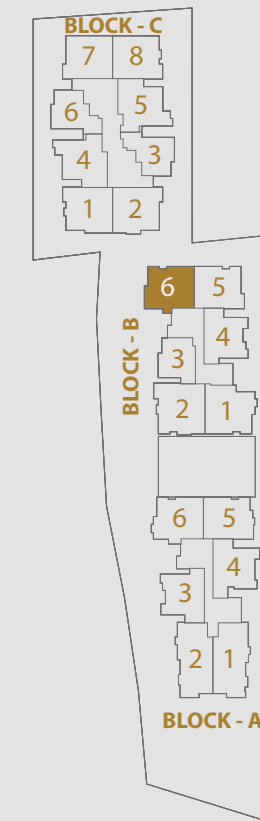

FLAT-6



Floor Plan

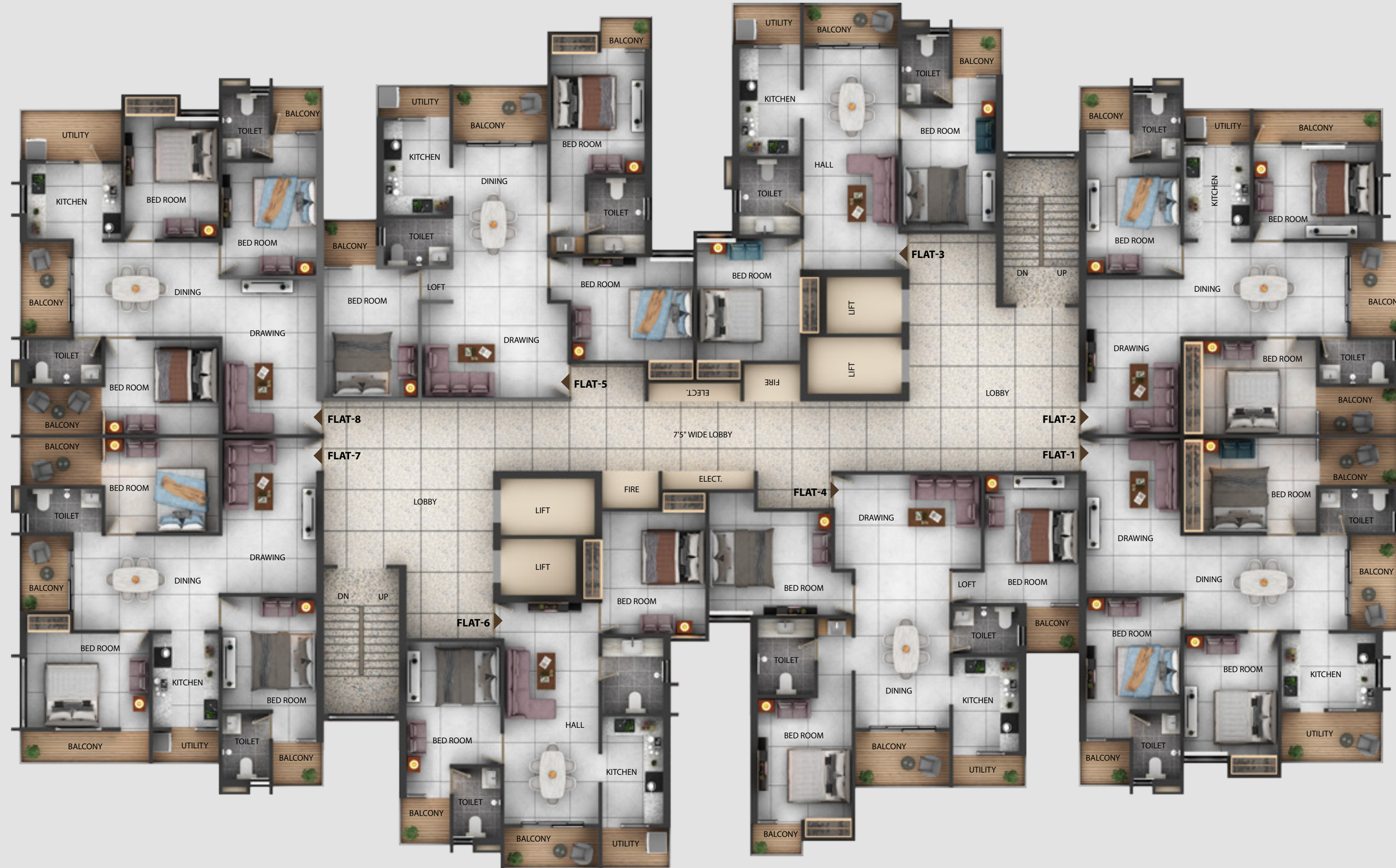

Block-C | Typical 1st To 9th Floor

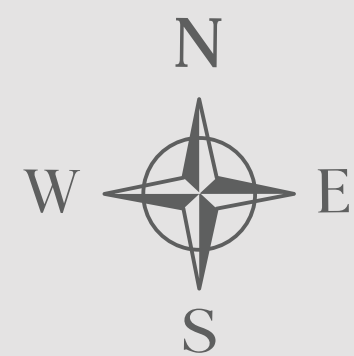

FLAT	TYPE	CARPET AREA	BUA	SBUA	UNIT	TYPE	CARPET AREA	BUA	SBUA
FLAT-1	3 BHK	1128 SQFT	1203 SQFT	1503 SQFT	FLAT-5	3 BHK	1128 SQFT	1210 SQFT	1513 SQFT
FLAT-2	3 BHK	1132 SQFT	1201 SQFT	1501 SQFT	FLAT-6	2 BHK	836 SQFT	901 SQFT	1126 SQFT
FLAT-3	2 BHK	845 SQFT	911 SQFT	1139 SQFT	FLAT-7	3 BHK	1080 SQFT	1152 SQFT	1440 SQFT
FLAT-4	3 BHK	1128 SQFT	1199 SQFT	1499 SQFT	FLAT-8	3 BHK	1087 SQFT	1162 SQFT	1453 SQFT



Unit Plans



Block-C | Typical 1st To 9th Floor

FLAT	1
TYPE	3 BHK
CARPET AREA	1128 SQFT
BUA	1203 SQFT
SBUA	1503 SQFT

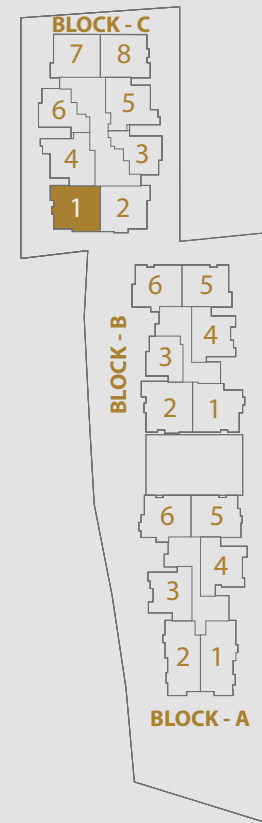

Block-C | Typical 1st To 9th Floor

FLAT	2
TYPE	3 BHK
CARPET AREA	1132 SQFT
BUA	1201 SQFT
SBUA	1501 SQFT

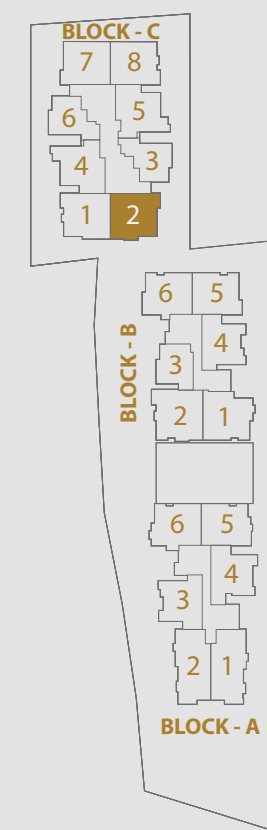

Unit Plans



Block-C | Typical 1st To 9th Floor

FLAT	3
TYPE	2 BHK
CARPET AREA	845 SQFT
BUA	911 SQFT
SBUA	1139 SQFT

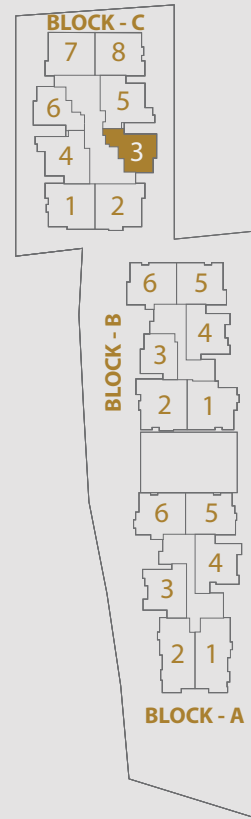

Block-C | Typical 1st To 9th Floor

FLAT	4
TYPE	3 BHK
CARPET AREA	1128 SQFT
BUA	1199 SQFT
SBUA	1499 SQFT

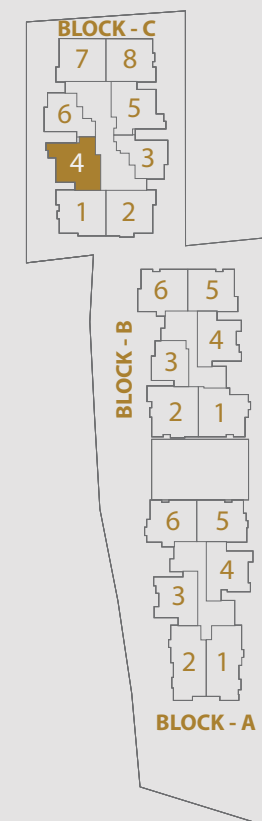

Unit Plans

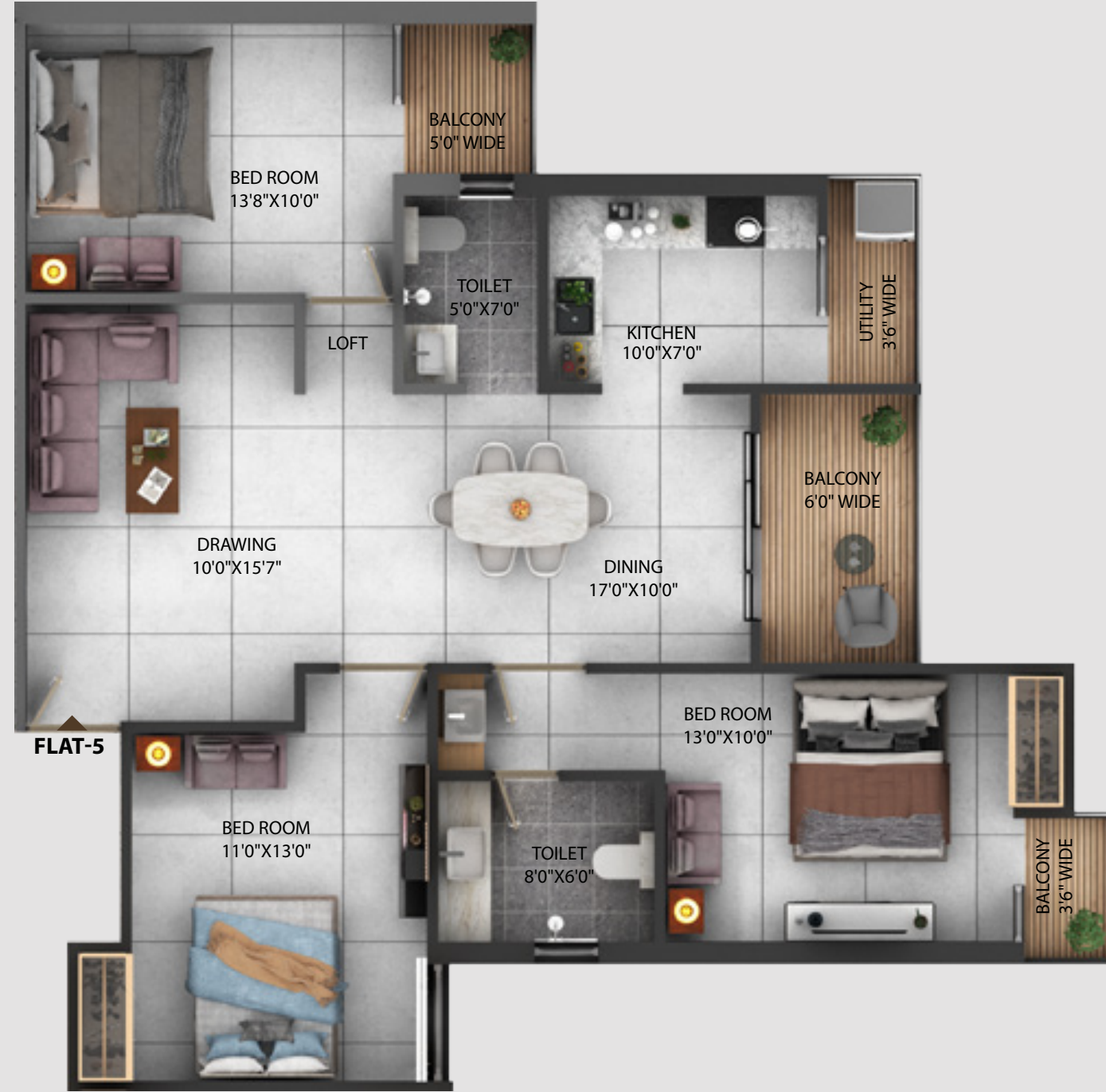

Block-C | Typical 1st To 9th Floor

FLAT	5
TYPE	3 BHK
CARPET AREA	1128 SQFT
BUA	1210 SQFT
SBUA	1513 SQFT

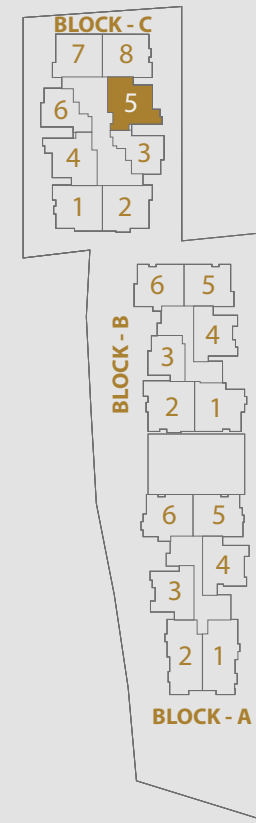

Block-C | Typical 1st To 9th Floor

FLAT	6
TYPE	2 BHK
CARPET AREA	836 SQFT
BUA	901 SQFT
SBUA	1126 SQFT

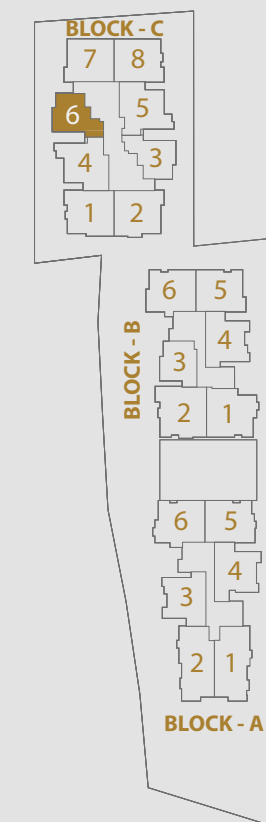

Unit Plans



FLAT-7

Block-C | Typical 1st To 9th Floor

FLAT	7
TYPE	3 BHK
CARPET AREA	1080 SQFT
BUA	1152 SQFT
SBUA	1440 SQFT

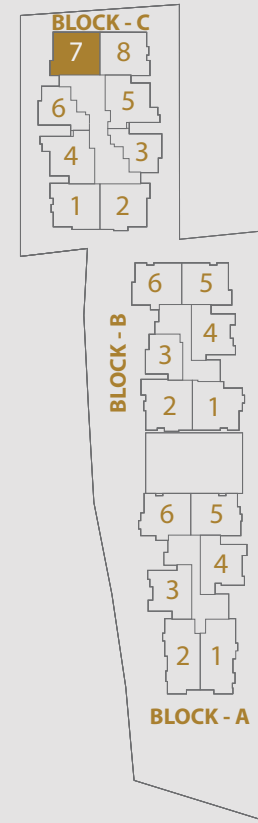

Block-C | Typical 1st To 9th Floor

FLAT	8
TYPE	3 BHK
CARPET AREA	1087 SQFT
BUA	1162 SQFT
SBUA	1453 SQFT

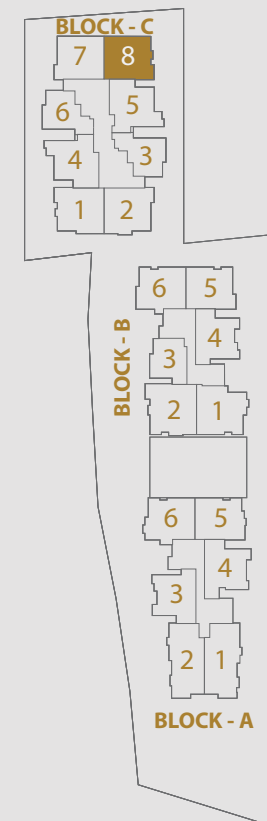

FLAT-8



Completed Projects

HARI OM TOWER RESIDENTIAL COMPLEX
Ranchi

HARI OM TOWER COMMERCIAL COMPLEX
Ranchi

MAHESHWARI TRIVENI APARTMENT
Muzaffarpur

PREM HEIGHT
Ranchi

HARI OM TOWER RESIDENCY
Ranchi

HARI OM TOWER EXTENSION
Ranchi

BHASKAR RESIDENCE
Ranchi

NAND HARI OM
Ranchi

SHANTI HARI TOWER
Jamshedpur

HARI OM TOWER HERITAGE PHASE I
Ranchi

MIRA TOWER
Ranchi

KRITI KUNJ
Ranchi

IPSITA, KOKAR
Ranchi

HARI OM TOWER
Gutua

Ongoing Projects



Hari Om Tower Heritage Phase II
Ranchi



Hari Om Tower
Morabadi



Hari Om Darbar
Ranchi

Upcoming Projects



Hari Om "X-Perion"
Ranchi



IGBC



Confederation of Indian Industry

Indian Green Building Council (IGBC)

hereby precertifies

Hari Om Tower Pundag

Thana:228 Pundag; Khata No: 336,91; Plot No: 112,115
(IGBC Registration No. GH2100087)

*The project has demonstrated intent to design and build
high performance building in accordance with*

IGBC Green Homes Rating System

Precertified Gold

August 2022

(Precertification is valid for 3 years, renewed based on six monthly progress updates till certification)

Sharukh Mistry
Chair, IGBC Green Homes

Gurmit Singh Arora
Chairman, IGBC

K S Venkatagiri
Executive Director, CII-Godrej GBC



Abode Of Happiness

Come to Hari Om Pundag and enter your very own world of comfort, convenience, nature and happiness! Enjoy an excellent location in the city, along with a lifestyle that's beyond comparison. It's time to experience the best a home can offer. It's time to Elevate your Life!

Come home to the good life!

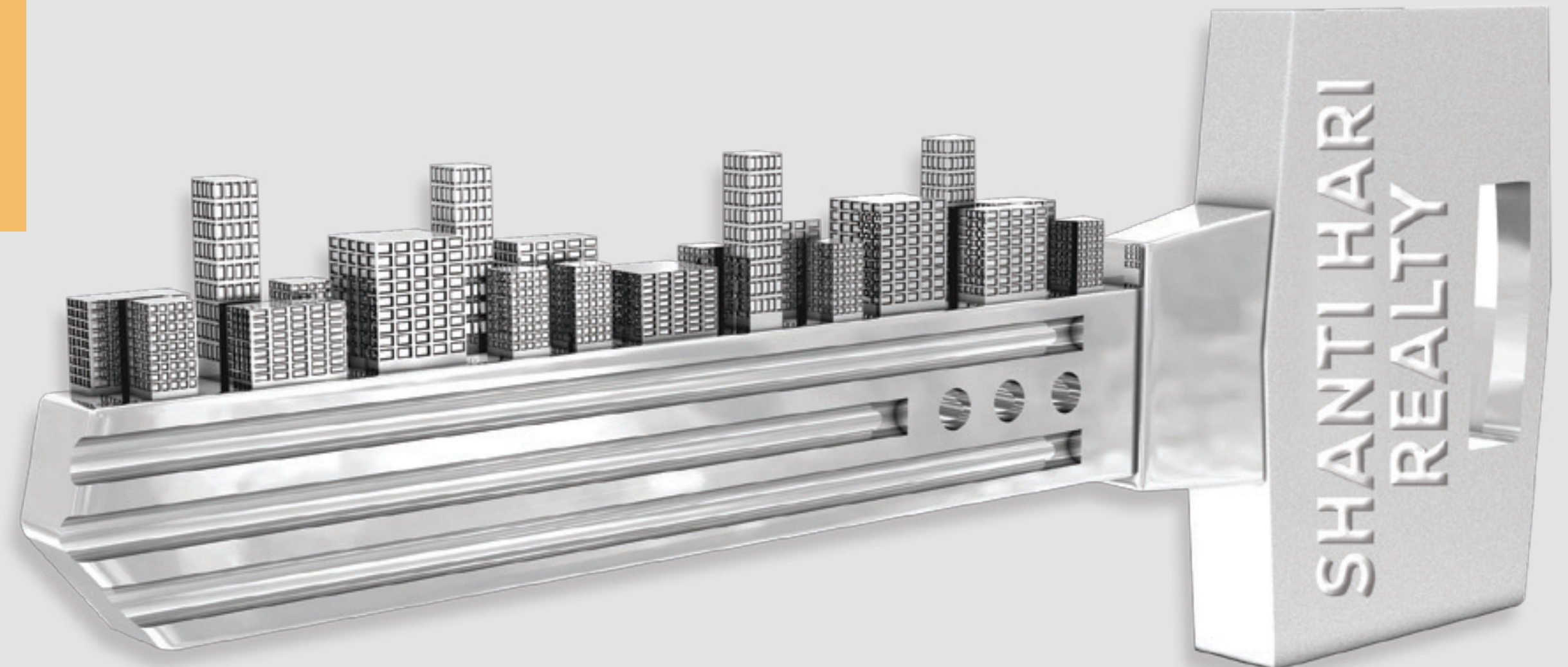

PROMOTERS



Shanti Hari Realty Pvt. Ltd.
216, Hari Om Tower Commercial Complex
Circular Road, Ranchi, Jharkhand.
Mob - 78589 89888 / 84048 00022
98353 70988 / 84048 00021

Email - shtvpltd@rediffmail.com

SITE ADDRESS

Behind pundag T.O.P., Argora kathal more road,
Pundag, Ranchi

ARCHITECTS

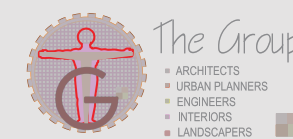

Ranchi

RERA NUMBER

JHARERA/PROJECT/224/2023

DISCLAIMER

This brochure is not a legal document. It describes the conceptual plan to convey the intent and purpose of HARIOM TOWER PUNDAG. The images are imaginary and the details mentioned in this brochure are tentative and subject to change at the sole discretion of the developer and/or architects.